

SUBSTITUTE
 1
 2
 3
 4
 5
 6
 7

SECRET CODE

**DATOS TÉCNICOS/
 TECHNICAL DATA**
 Freq. 433.92MHz
 6Vdc 2xCR2016 (3Vdc) / 10mA
 Radiated power <10mW
 Temp. -20°C _ +55°C

BATTERY REPLACEMENT



COD. 1221006 / 3.1



STANDARD PROGRAMMING

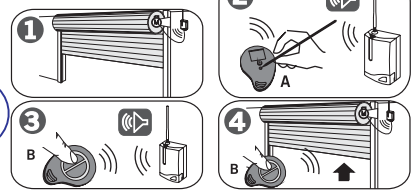

A=emisor dado de alta en una instalación / émetteur déjà mémorisé dans une installation / transmitter registered in an installation / Installation angemeldet
 Sender / trasmettitore memorizzato in una installazione - **B**=nuevo emisor / nouvel émetteur / new transmitter / neuer Sender / nuovo trasmettitore